

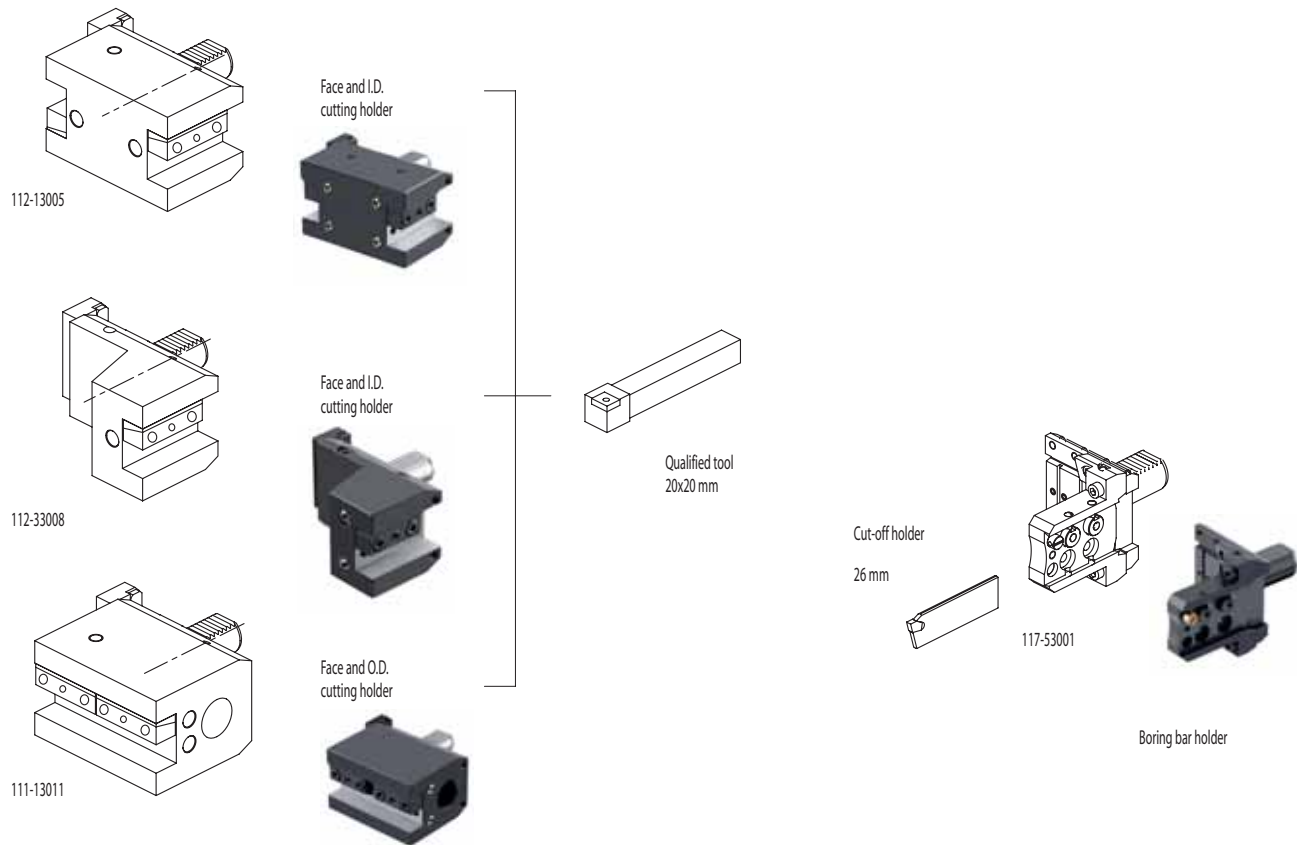

KINTEK

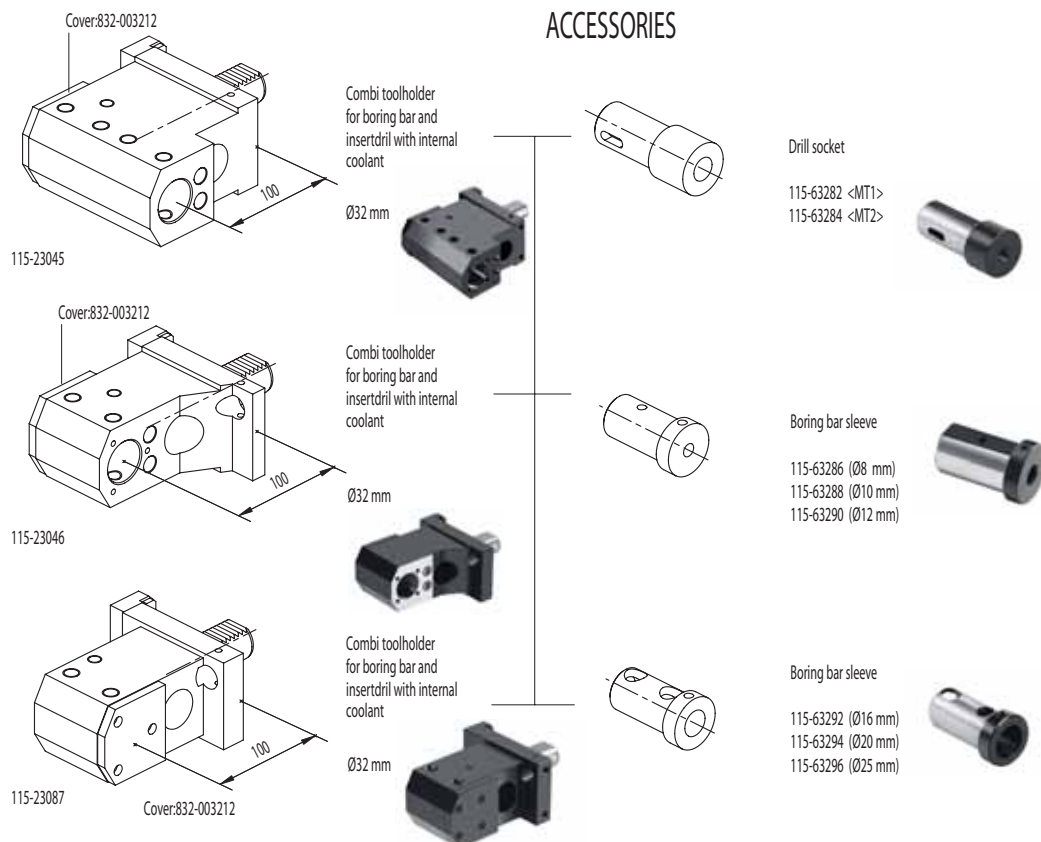

ACCESSORIES





OKUMA (VDI40)

LT15M - LT300M - MT250 - LB300 - LB300M - LV300

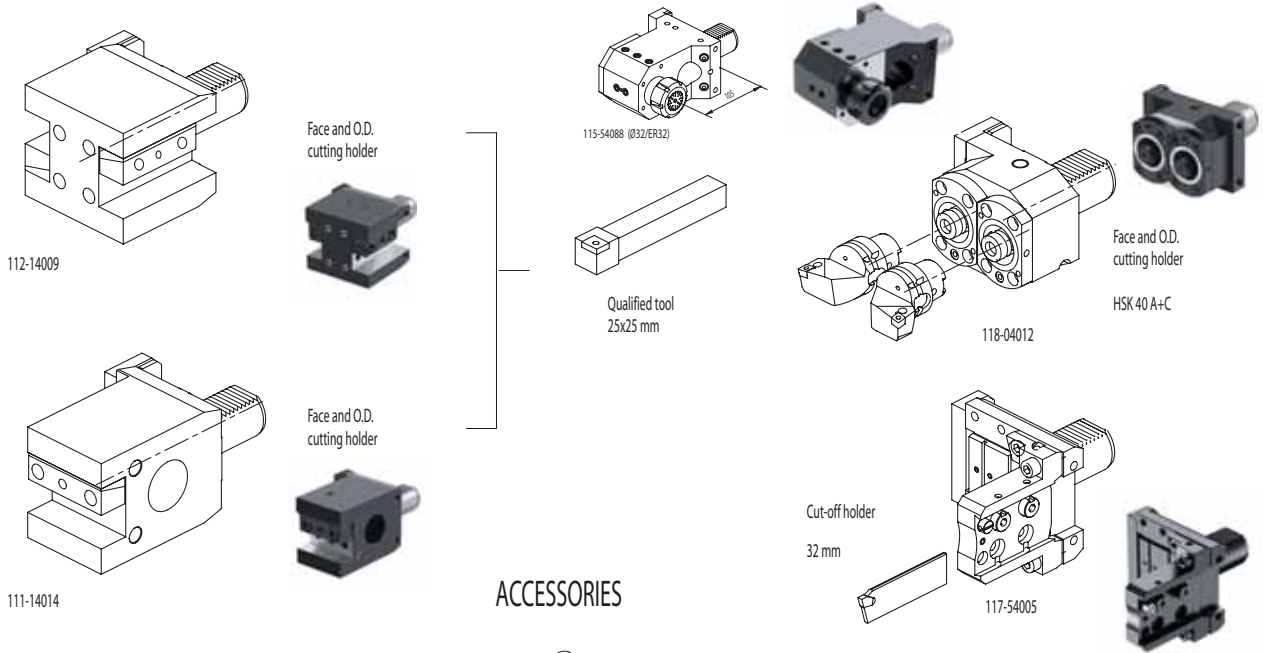

ACCESSORIES

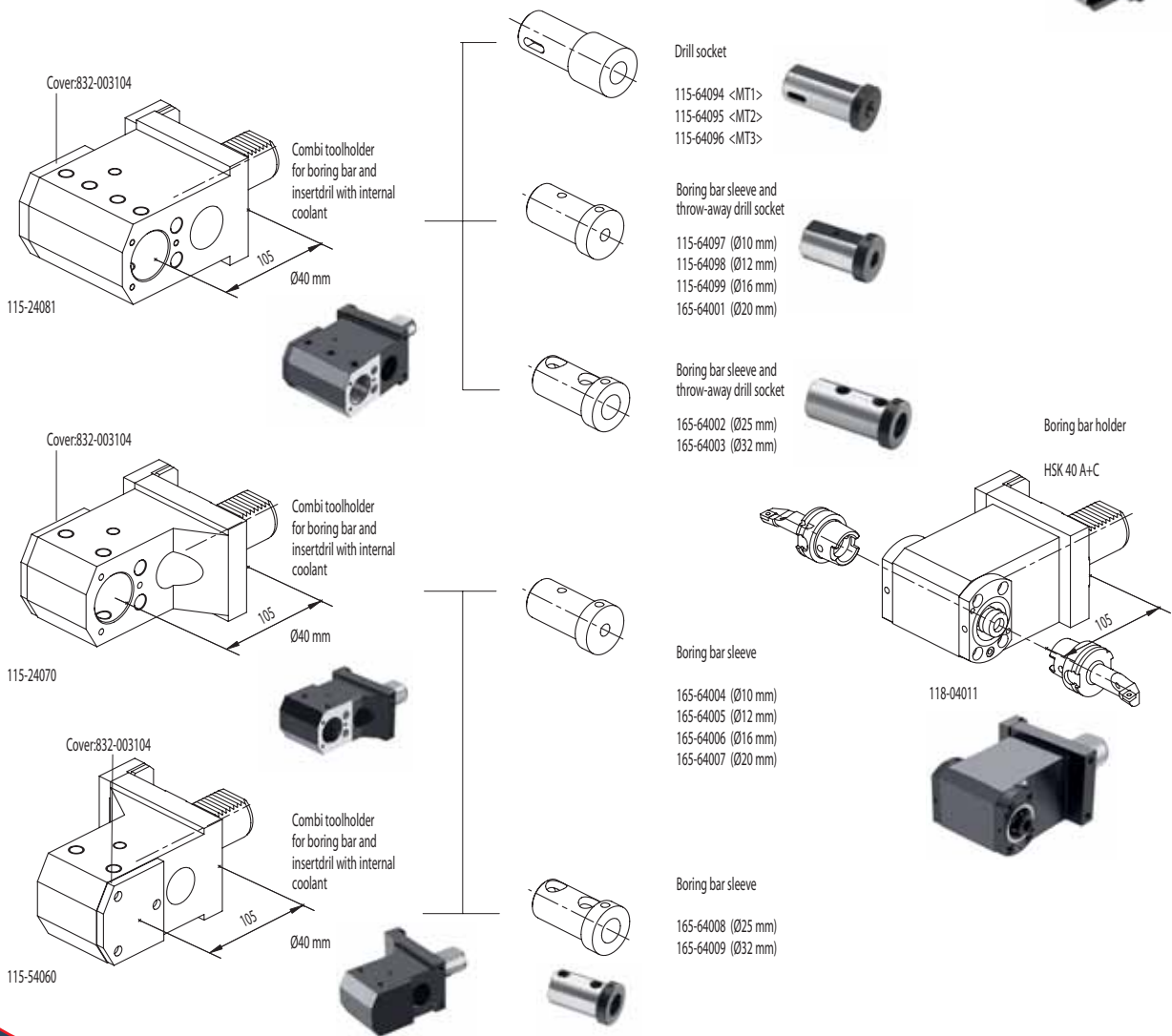

OKUMA
LB15 - LB25
LB15II - LB300

HAAS
SL20 - SL30

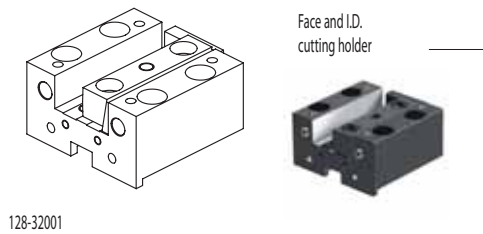
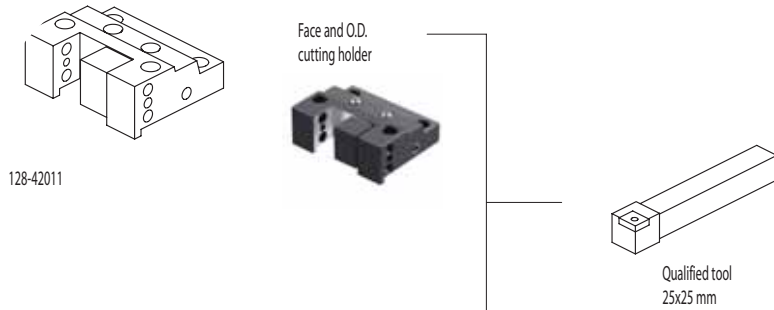

CONNECTION

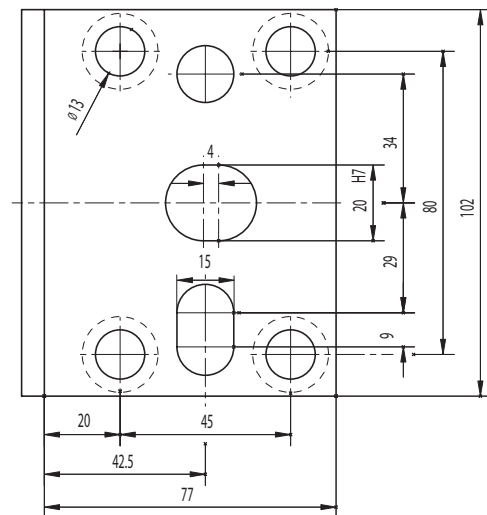

ACCESSORIES

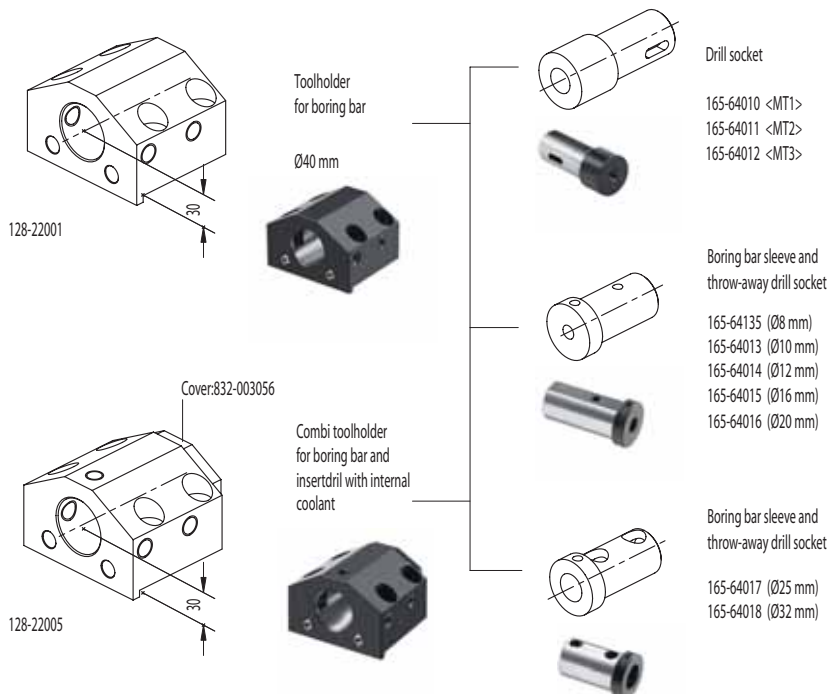



OKUMA (VDI40) LB15IIMW

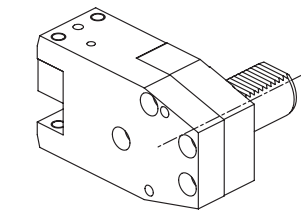

112-24007

Face and I.D.
cutting holder

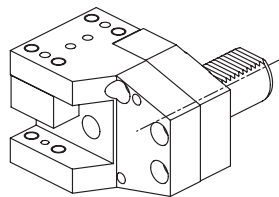

111-64005

Face and O.D.
cutting holder

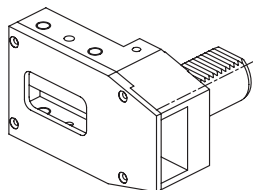

111-64006

Face and O.D.
cutting holder

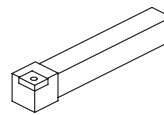

Qualified tool
25x25 mm

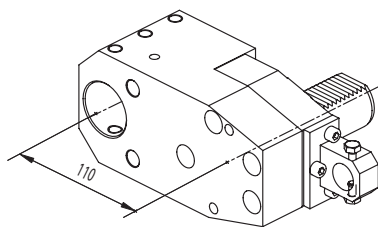

115-24068

Toolholder
for boring bar

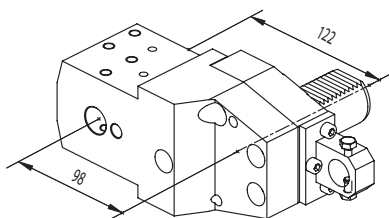

115-24067

Double toolholder
for boring bar



ACCESSORIES

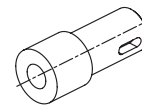

Drill socket

- 165-64021 <MT1>
- 165-64022 <MT2>
- 165-64023 <MT3>



Boring bar sleeve

- 165-64024 (Ø10 mm)
- 165-64025 (Ø12 mm)
- 165-64026 (Ø16 mm)
- 165-64027 (Ø20 mm)

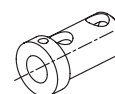
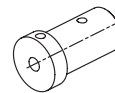

Boring bar sleeve

- 165-64028 (Ø25 mm)
- 165-64029 (Ø32 mm)



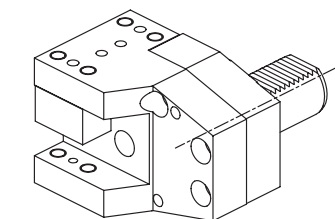

111-64009

Face and O.D.
cutting holder

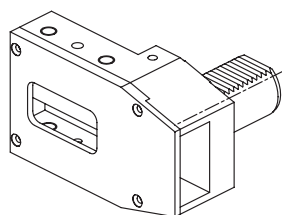

111-64006

Face and O.D.
cutting holder

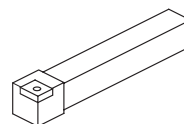

Qualified tool
25x25 mm

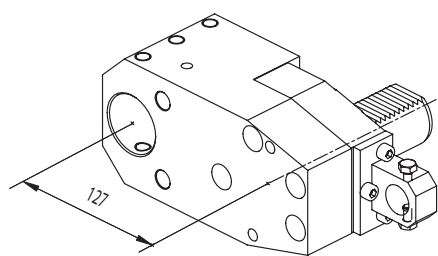

115-24093

Toolholder
for boring bar

Ø40 mm



ACCESSORIES

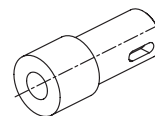

Drill socket

- 165-64021 <MT1>
- 165-64022 <MT2>
- 165-64023 <MT3>

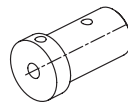

Boring bar sleeve

- 165-64024 (Ø10 mm)
- 165-64025 (Ø12 mm)
- 165-64026 (Ø16 mm)
- 165-64027 (Ø 20 mm)

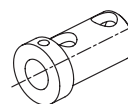

Boring bar sleeve

- 165-64028 (Ø25 mm)
- 165-64029 (Ø32 mm)





OKUMA

Mac Turn 250/350/400

Multus B250/B300/B400

ATC Turret (HSK63T)

ICTM STANDARD

For turning

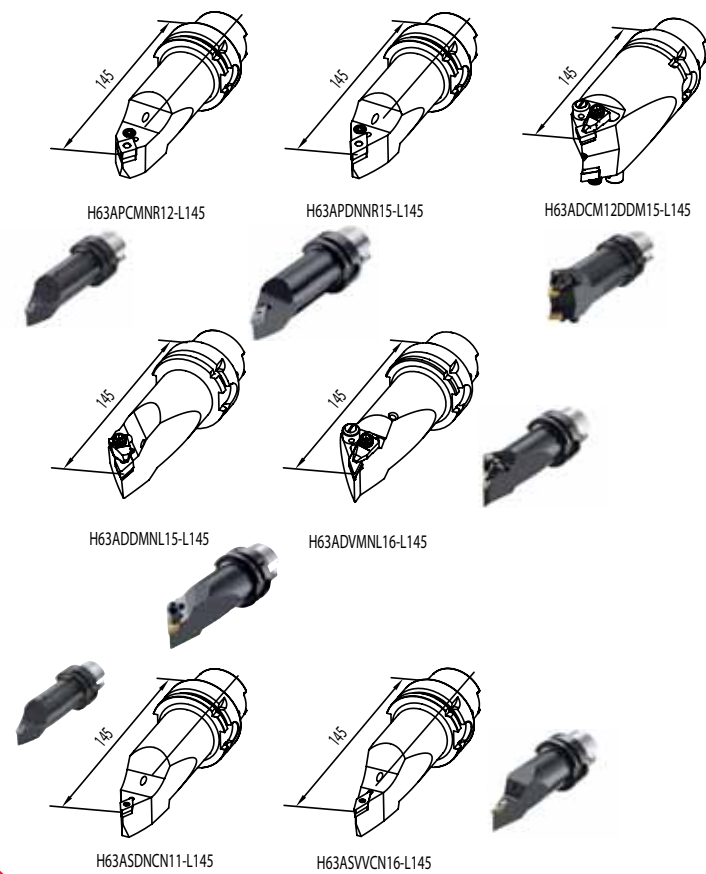
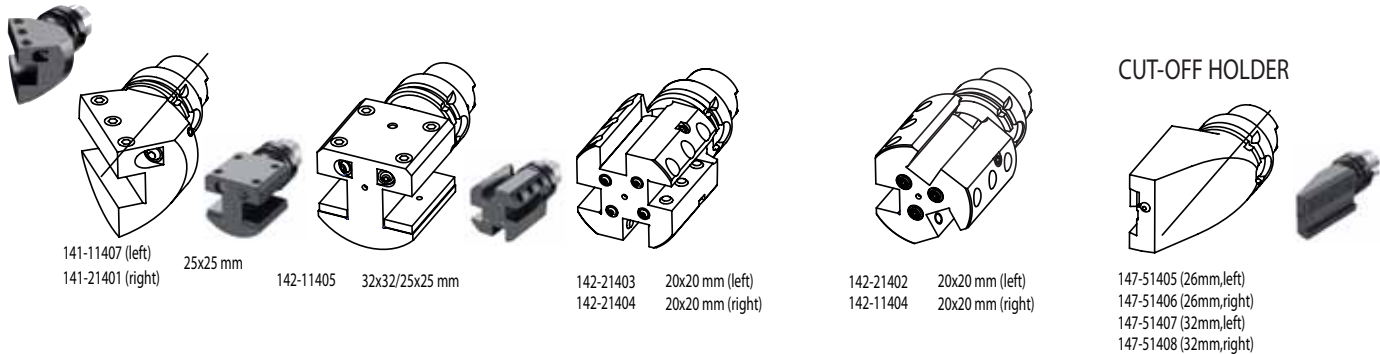
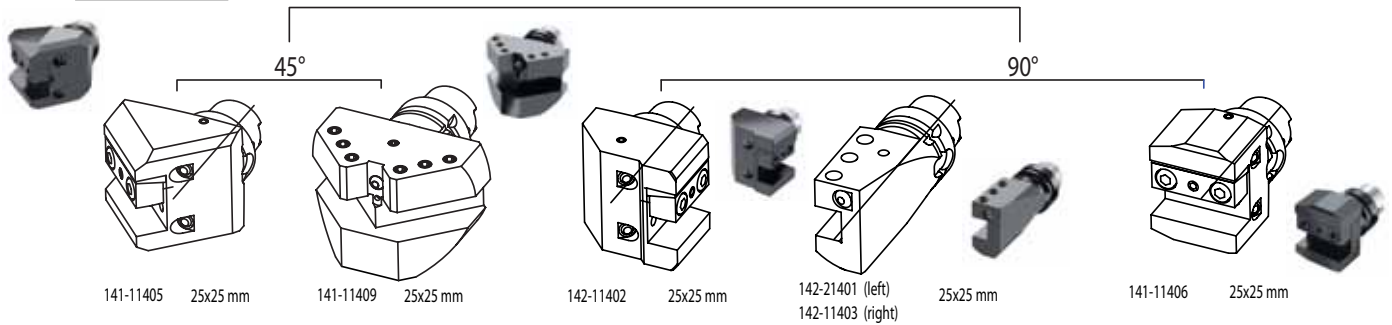

BORING BAR HOLDER

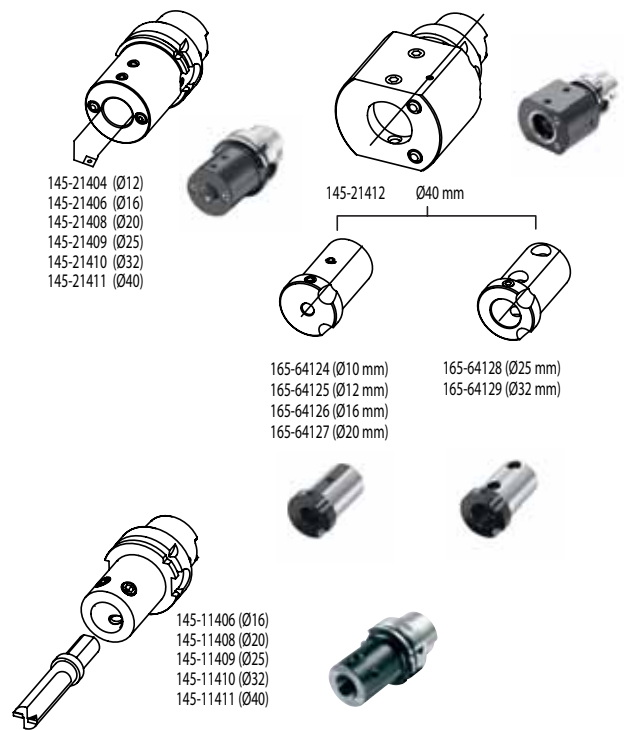

Lower Turret (VDI 40)

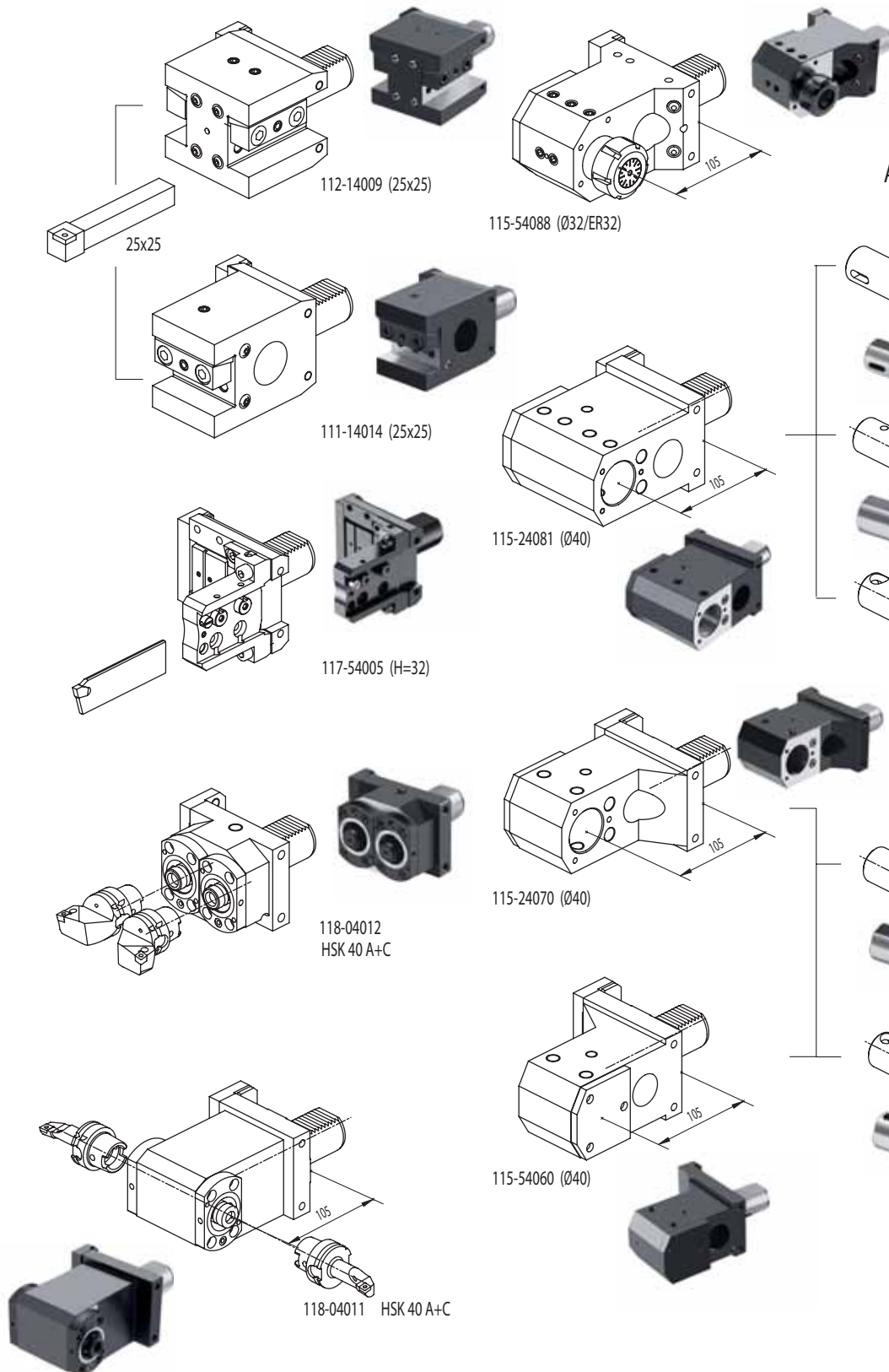

ACCESSORIES

Drill socket

- 115-64094 <MT1>
- 115-64095 <MT2>
- 115-64096 <MT3>

Boring bar sleeve and throw-away drill socket

- 115-64097 (Ø10 mm)
- 115-64098 (Ø12 mm)
- 115-64099 (Ø16 mm)
- 165-64001 (Ø20 mm)

Boring bar sleeve and throw-away drill socket

- 165-64002 (Ø25 mm)
- 165-64003 (Ø32 mm)

Boring bar sleeve

- 165-64004 (Ø10 mm)
- 165-64005 (Ø12 mm)
- 165-64006 (Ø16 mm)
- 165-64007 (Ø20 mm)

Boring bar sleeve

- 165-64008 (Ø25 mm)
- 165-64009 (Ø32 mm)



OKUMA

Mac Turn 550

For turning

ATC Turret (HSK100A) ICTM STANDARD

45°

90°

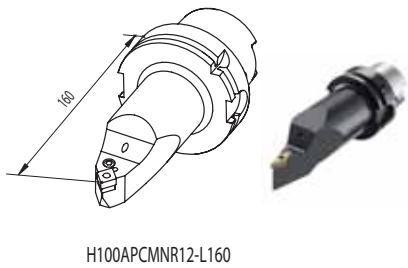
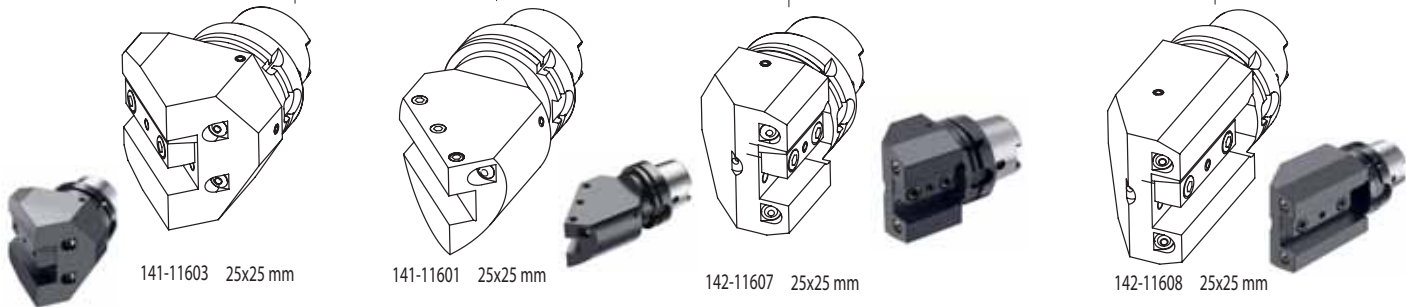

H100APCMNR12-L160

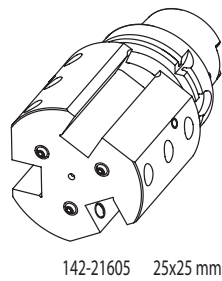

142-21605 25x25 mm

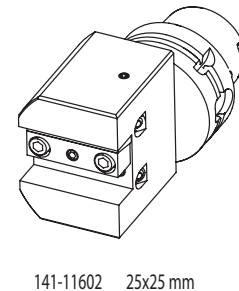

141-11602 25x25 mm

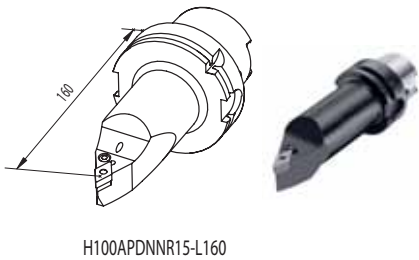

H100APDNNR15-L160



BORING BAR HOLDER

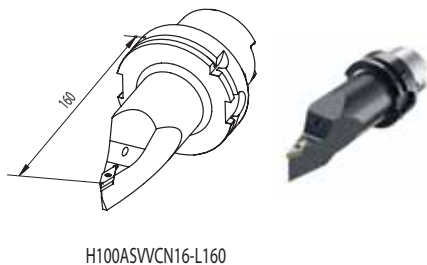

H100ASVVCN16-L160

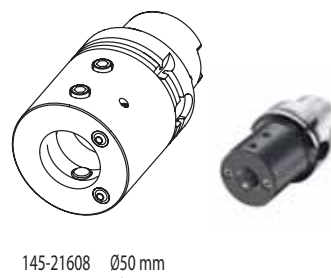

145-21608 Ø50 mm

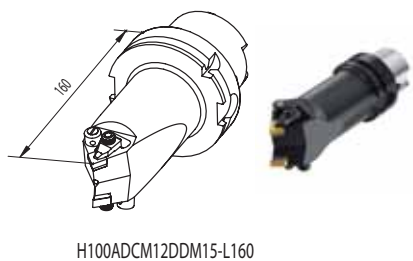

H100ADCM12DDM15-L160

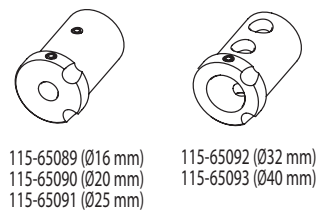

115-65089 (Ø16 mm)
115-65090 (Ø20 mm)
115-65091 (Ø25 mm)

115-65092 (Ø32 mm)
115-65093 (Ø40 mm)



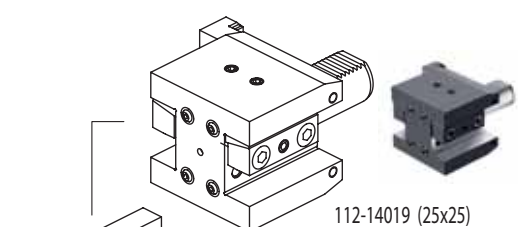

112-14019 (25x25)

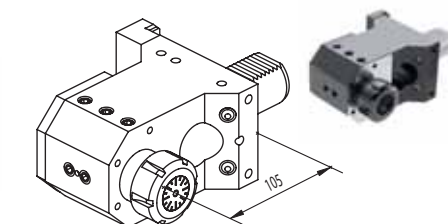

115-54092 (Ø32/ER32)

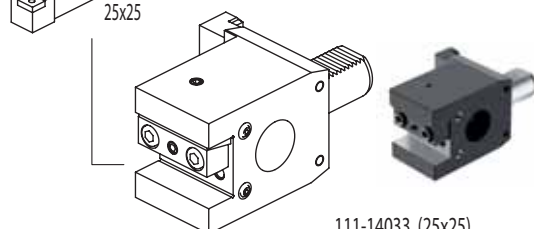

111-14033 (25x25)

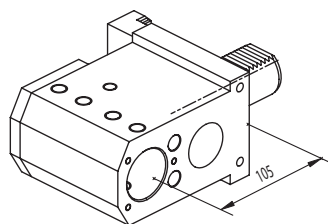

115-54072 (Ø40)

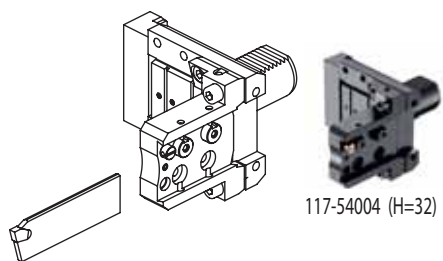

117-54004 (H=32)

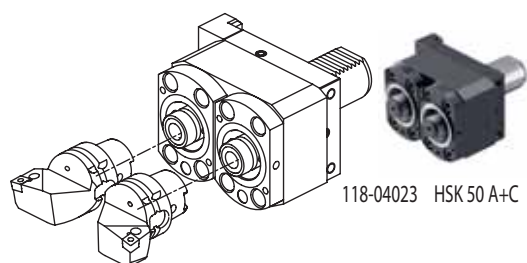

118-04023 HSK 50 A+C

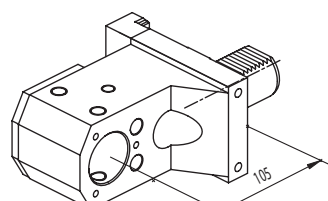

115-54073 (Ø40)



115-54074 (Ø40)

ACCESSORIES



Drill socket

115-64094 <MT1>

115-64095 <MT2>

115-64096 <MT3>



Boring bar sleeve and
throw-away drill socket

115-64097 (Ø10 mm)

115-64098 (Ø12 mm)

115-64099 (Ø16 mm)

165-64001 (Ø20 mm)

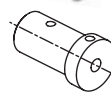

Boring bar sleeve and
throw-away drill socket

165-64002 (Ø25 mm)

165-64003 (Ø32 mm)



Boring bar sleeve

165-64124 (Ø10 mm)

165-64125 (Ø12 mm)

165-64126 (Ø16 mm)

165-64127 (Ø20 mm)

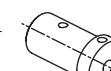
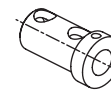

Boring bar sleeve

165-64008 (Ø25 mm)

165-64009 (Ø32 mm)



OKUMA (VDI40) LVT300

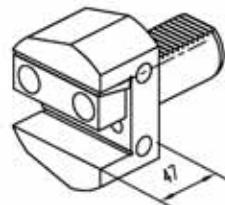

111-14041

Face and O.D.
cutting holder

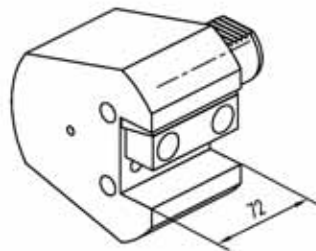

112-14021

Face and O.D.
cutting holder

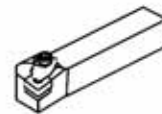

Qualified tool
25x25 mm

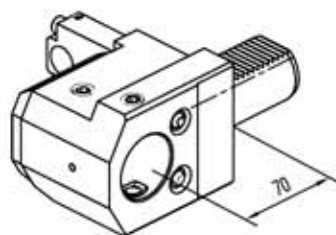

115-54068

Combi toolholder
for boring bar and
insertdrill

∅40 mm

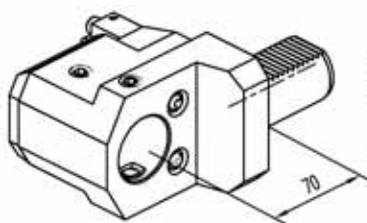

115-54069

Combi toolholder
for boring bar and
insertdrill

∅40 mm

ACCESSORIES

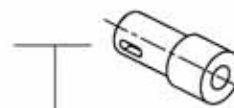

Drill socket

114-34034 <MT1>

114-34035 <MT2>



Boring bar sleeve

165-64124 (∅10 mm)

165-64125 (∅12 mm)

165-64126 (∅16 mm)

165-64127 (∅20 mm)



Boring bar sleeve

165-64128 (∅25 mm)

165-64129 (∅32 mm)

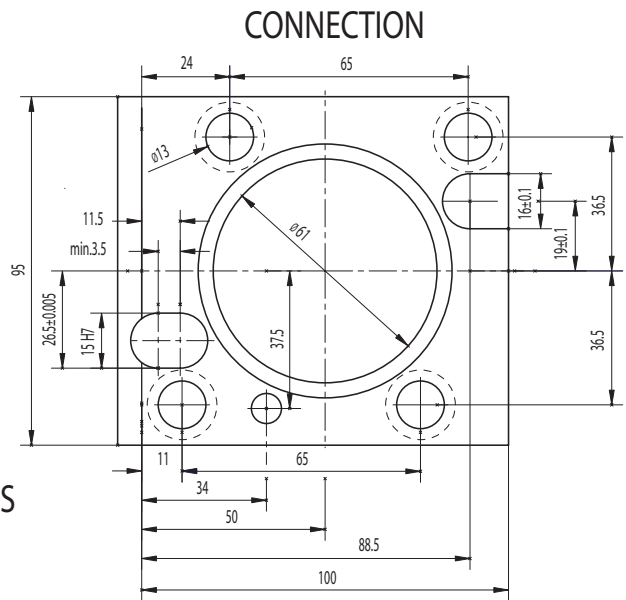
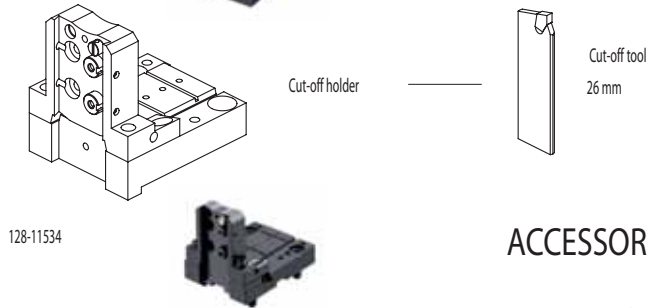
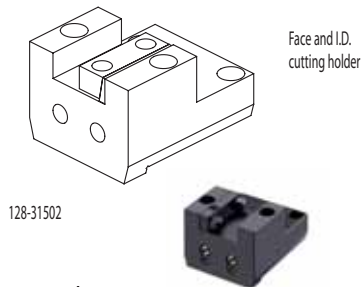
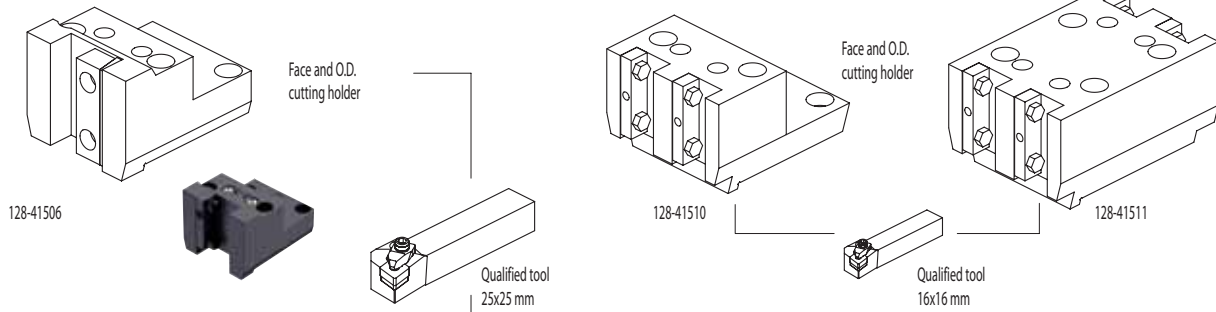

ACCESSORIES

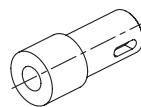
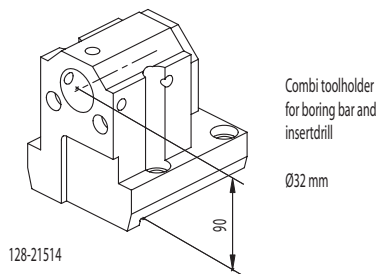
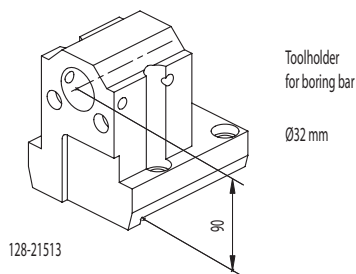

Drill socket
165-63295 <MT1>
165-63296 <MT2>

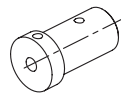

Boring bar sleeve
165-63289 (Ø8 mm)
165-63290 (Ø10 mm)
165-63291 (Ø12 mm)
165-63292 (Ø16 mm)

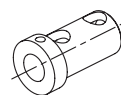

Boring bar sleeve
165-63293 (Ø20 mm)
165-63294 (Ø25 mm)

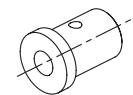

Throw-away drill socket
165-63297 (Ø16 mm)
165-63298 (Ø20 mm)
165-63299 (Ø25 mm)



OKUMA

LB2500 EX (M)
LB3000 EX (M, MY)

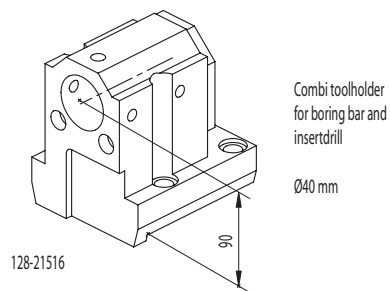
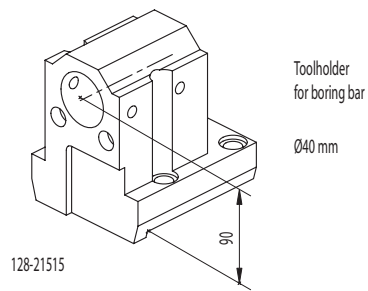
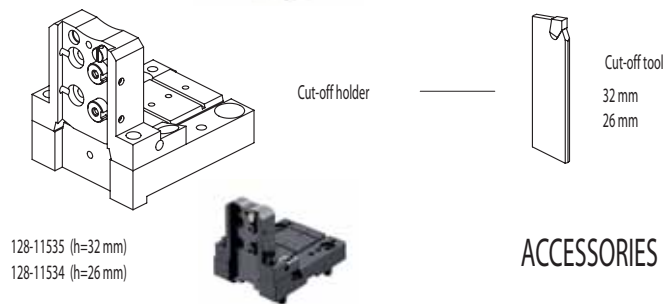
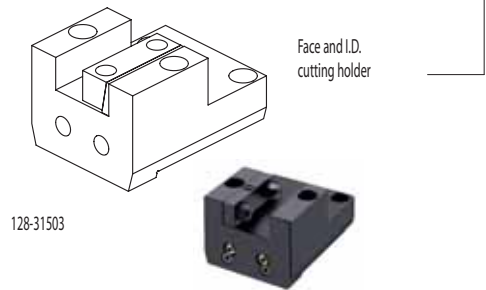
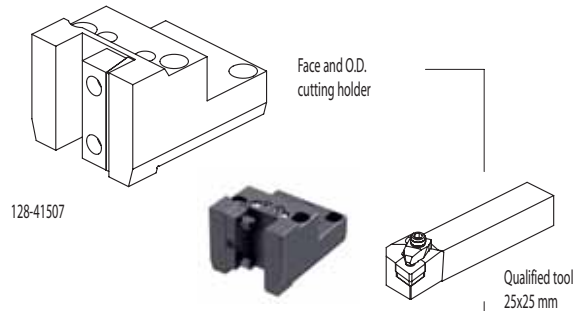

ACCESSORIES

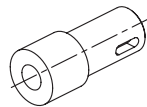

Drill socket

- 165-64010 <MT1>
- 165-64011 <MT2>
- 165-64012 <MT3>

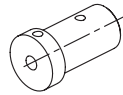

Boring bar sleeve

- 165-64135 (Ø8 mm)
- 165-64013 (Ø10 mm)
- 165-64014 (Ø12 mm)
- 165-64015 (Ø16 mm)
- 165-64016 (Ø20 mm)

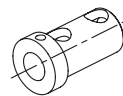

Boring bar sleeve

- 165-64019 (Ø25 mm)
- 165-64020 (Ø32 mm)

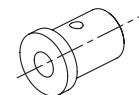

Throw-away drill socket

- 165-64203 (Ø16 mm)
- 165-64204 (Ø20 mm)
- 165-64205 (Ø25 mm)
- 165-64206 (Ø32 mm)

CONNECTION

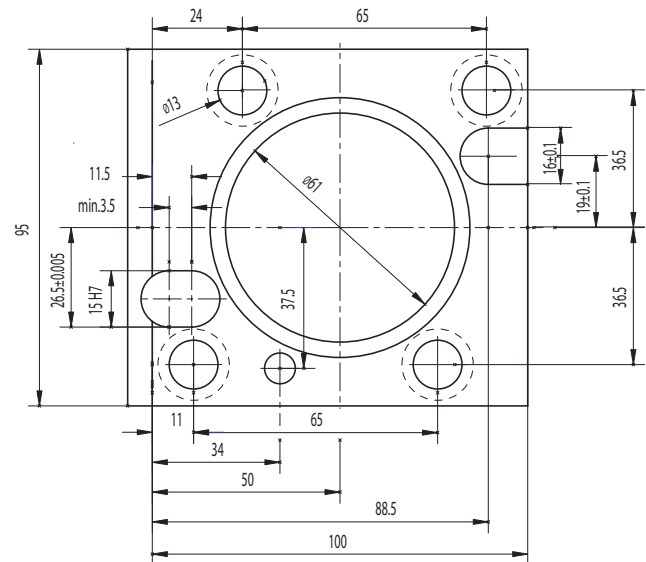

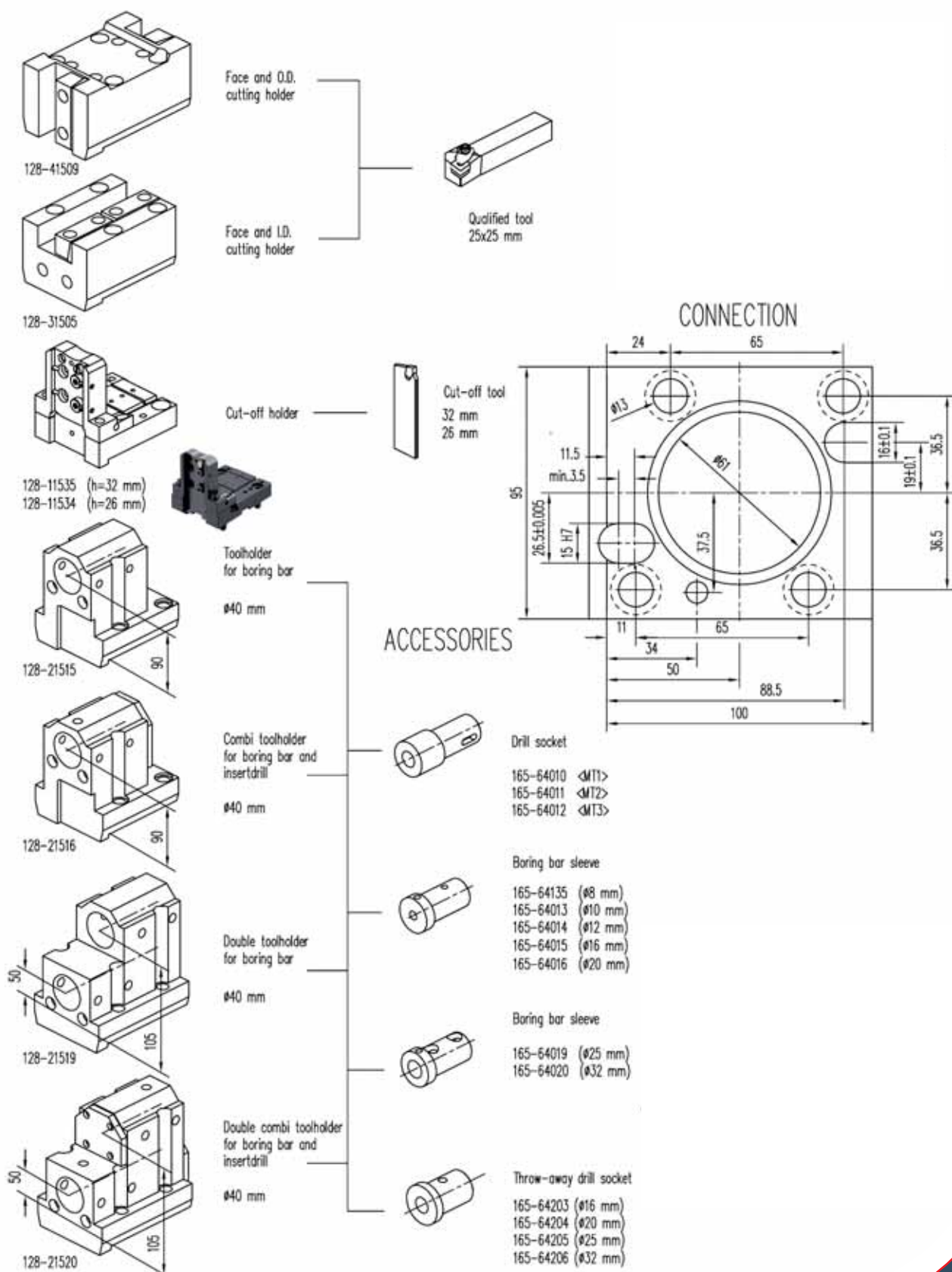



OKUMA

LB4000 EX (M, MY)

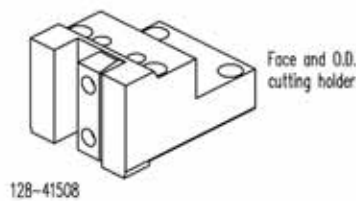

Face and O.D. cutting holder

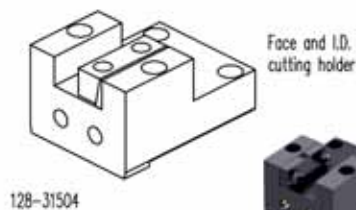

Face and I.D. cutting holder

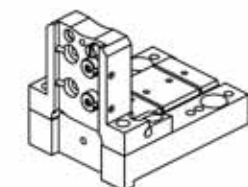

Cut-off holder

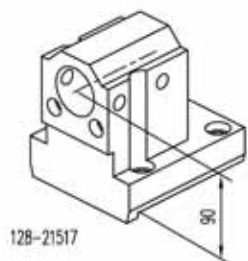

Toolholder for boring bar

Ø40 mm

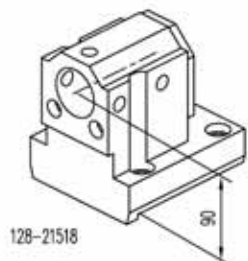

Combi toolholder for boring bar and insert drill

Ø40 mm

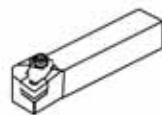

Qualified tool
25x25 mm



Cut-off tool
32 mm

CONNECTION

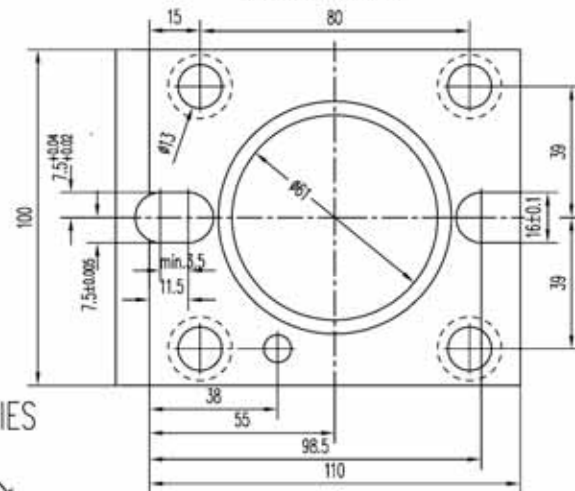

ACCESSORIES



Drill socket

- 165-64010 <MT1>
- 165-64011 <MT2>
- 165-64012 <MT3>

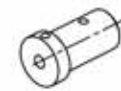

Boring bar sleeve

- 165-64135 (Ø8 mm)
- 165-64013 (Ø10 mm)
- 165-64014 (Ø12 mm)
- 165-64015 (Ø16 mm)
- 165-64016 (Ø20 mm)



Boring bar sleeve

- 165-64019 (Ø25 mm)
- 165-64020 (Ø32 mm)



Throw-away drill socket

- 165-64203 (Ø16 mm)
- 165-64204 (Ø20 mm)
- 165-64205 (Ø25 mm)
- 165-64206 (Ø32 mm)



KINTEK srl

Via Goretta 88/G, 10072 Mappano Fraz. di Caselle (TO) ITALIA

tel. +39.011.9968065 fax +39.011.9965662

<http://www.kintek.it> e-mail: info@kintek.it